

# SVD-3020

MPEG4/JPEG Dual Codec, Power Over Ethernet  
Day&Night, Optical x10, 360° Endless

## High Speed Mini IP Dome Camera

SVD-3020 Network Dome Camera provides advanced solutions for viewing, recording and retrieving video over computer networks, including the Internet. SVD-3020 Network Dome Camera compresses Video, and then transmits the compressed video over computer networks at speeds up to 30 fps.

SVD-3020 Network Dome Camera delivers superior quality MPEG-4 video in all light conditions over IP networks. SVD-3020 network dome camera enables a continuous 360-degree pan operation and support 240 preset positions.

Fast, high precision PTZ control using mouse or Joystick makes it easy to track objects of interest.

The SVD-3020 can capture color video in light conditions down to 0.7 lux, and the SVD-3020 with its automatic or manually removable IR-cut filter is able to capture black and white video in dark conditions as low as 0.02 lux.

The SVD-3020 is perfect for professional security installations at airports, railway stations, prisons, warehouses, manufacturing facilities, shopping centers and school campuses.



### Features

- D1 (704 X 480) at 30 fps : NTSC / D1 (704 X 576) at 25 fps: PAL
- Monitor live video transmitted in real-time
- Simultaneous video and audio signal transmission
- Built-in Web Server and Network Interface
- No PC Needed for Operation - Standalone Unit
- Linux Based Operating System
- Embedded Motion Detection function
- Supports network environments
- Easy Firmware Update through Network
- E-mail and FTP transmission
- World Smallest High Speed Dome Camera (3.5± Bubble Dome)
- Built in Zoom Camera (Optical x10, Digital x10) with Auto ICR D/N
- 0~360 Pan Angle / 0~94 Tilt Angle (Endless pan Rotation)
- 1/4" Interline Transfer CCD
- Wall/Ceiling Mount Bracket Optional

### OPTIONAL ACCESSORIES

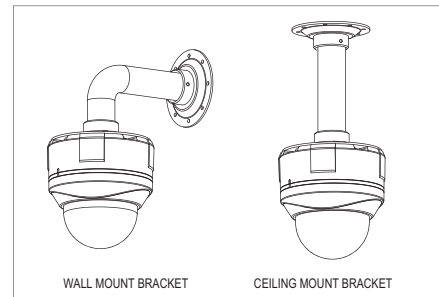

### BRACKET INSTALLATION

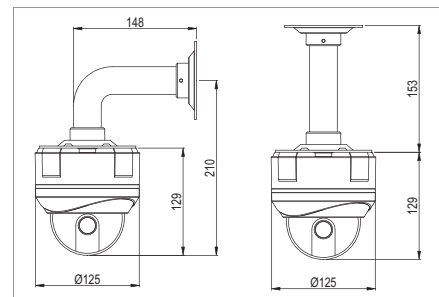

### DIMENSIONS

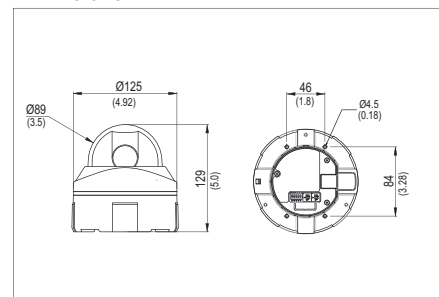

# SVD-3020 HIGH SPEED MINI IP DOME CAMERA

## Specification

<b>CAMERA</b>	Image Sensor	NTSC : 1/4" Interline Transfer CCD , 768(H) X 494(V)		
		PAL : 1/4" Interline Transfer CCD , 752(H) X 582(V)		
	Optics	10X, f=3.8 to 38.0mm(F1.8)		
	Min Focus Distance	1m		
	Scanning System	2:1 Interlace		
	Frequency	(H) 15.734KHZ (V) 59.94HZ (NTSC), (H) 15.625KHZ (V) 50HZ (PAL)		
	Resolution	500 TV Lines(Min.) : Color(Wide) / 570 TV Lines(Min.) : B/W(Wide)		
	S/N Ratio	50dB (AGC off, Weight ON)		
	Gamma Correction	0.45 or 1 (Selectable)		
	D.zoom	OFF/ON(X2~X10)		
	Minimum Illumination	0.7 Lux/ F1.8(50 IRE) ; Color 0.02 Lux/F1.8 (50 IRE) ;B/W		
	Day & Night	Auto 1, Auto 2, Color, B/W(ICR)		
	White Balance	ATW/AWC/Manual (1800°K ~ 10,500°K)		
Video Output	CVBS : 1.0Vp-p/75Ω			
<b>DOME</b>	Pan Angle / Speed	360° Continuous Rotation, 0.1° ~ 400°/sec		
	Tilt Angle / Speed	0° ~ 94°, 0.1° ~ 300°/sec (According to Zoom Speed)		
	Preset Speed	Max. 400 /sec		
	Preset	1 ~ 240 Preset		
	Guard Tour	8 Guard Tour (Preset, Pattern, Autoscan, Tour Input)		
	Pattern	8 Pattern, 960sec Memory		
	Communication	RS-485, Baud Rate : 2400(default),4800,9600,38400bps		
	Alarm	4 Alarm Inputs, 1 Alarm output		
	Auto Scan	8 Auto Scan		
	Dome ID	Camera 255 ID : Network IP		
	Screen Display	Camera ID, Pan/Tilt Angle, Zoom		
	<b>Network</b>		NTSC	PAL
		Image Resolution	704x480,704x240,352x240 160x240,160x96	704x576,704x288,352x288 160x288,160x128
Frame rate		Max. 30fps @ D1	Max. 25fps @ D1	
Video Compression		MPEG4 / JPEG		
Video out		1CH		
Audio Compression		G.711 (Two-way Audio)		
Network Protocol		TCP/IP, DHCP, FTP, SMTP, HTTP, PPPoE, PPP, ARP		
Compression Rate		Min. 500 Kbps to Max. 2 Mbps		
System Requirements		Microsoft Window 98 SE or higher Intel Pentium 800MHz or faster 256 MB or higher		
Supported Web browser		Internet Explorer 6.x or later		
Monitoring Tools		Web Browser or Monitor Software		
Monitoring Via Network		Maximum 20 persons		
Event Notification/ Via E-Mail		Yes		
Motion Detection		Yes (16 x 16)		
Operation Temperature		-10°C to +50°C (14°F to 122°F)		
Alarm In/Out		4 / 1		
Audio In/Out		1 / 1		
Network	RJ-45 (10/100 Base-T)			
<b>GENERAL</b>	Certification	CE, FCC CLASS A 1995		
	Power Source	DC12V , 750mA		
	Operating Temperature	0 °C ~ 50 °C (32 °F ~ 122 °F)		
	Operating Humidity	0 ~ 90%RH (Non-Condensing)		
	Storage Temperature	-20 °C ~ 60 °C (-4 °F ~ 140 °F)		
	Material	Polycarbonate/Aluminum		
	Color	IVORY/ Black		
	Dimension	3.5" Clear Bubble Dome(φ125 x 129.4)		
	Weight	Approx. 780g		

## Configuration

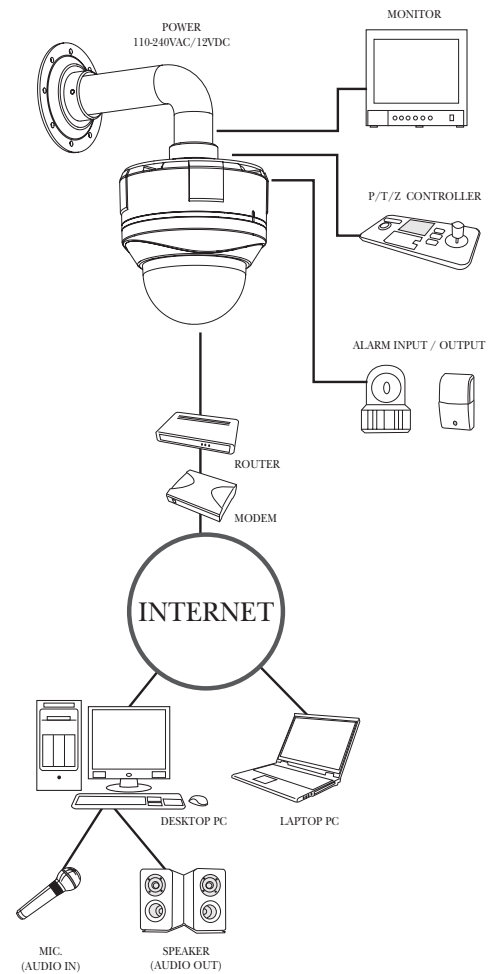

## Software



Multi Viewer@PC  
: View& Record 16 Cameras

**seorim** digital technology

Seorim Technology Co., Ltd  
#1001, daerung technotown vi, 493-6, gasan-dong, kumchun, seoul, korea, 153-803

Tel: +82-2-2108-5860  
Fax: +82-2-2108-5869  
E-mail: sales@seorimtech.com

[www.seorimtech.com](http://www.seorimtech.com)